

Committed to Providing Quality Products
with the Best Service

Uflow[®]
Automation
INDIA

Automation
Simplified...



Solenoid Valve

Angle Seat Valve

Rotary Coupling

Pneumatic Directional Control Valve

Actuator

Cylinder

One Touch Fitting

Ball Valve

Butterfly Valve



Country of Origin - INDIA



Uflow Automation is an engineering organization committed to provide complete solutions to customer's requirements. We are established in the year 2007 and progressing with a vision of applying finest engineering practices in valve manufacturing industry by our restless and high skilled **ENGINEERS**, standard organizational **PROCESSES** and superior quality **PRODUCTS**.

We are leading in solenoid valve manufacturing company in India, Know as **UFLOW** our range of products include - Pilot Operated Diaphragm Type Valves, Pneumatically Control Valves, Gas Solenoid valves, High Pressure Valves, Industrial Valves, Pneumatic Directional Control Valves, Rotary Coupling and Actuators. Our products are sold across INDIA and being exported outside India in various other countries.

Our Quality	Our Commitment	About Us
<ul style="list-style-type: none"> <input checked="" type="checkbox"/> In-House full scale testing facility. <input checked="" type="checkbox"/> Lean manufacturing practices / six sigma, kaizen, 5S. <input checked="" type="checkbox"/> Certified by : ISO 9001:2015 (TUV Nord), CE, ERDA, CIMFR, BIS, PESO. 	<ul style="list-style-type: none"> <input checked="" type="checkbox"/> To understand customer's need first before proposing our products. <input checked="" type="checkbox"/> To keep on providing competitive rate's by adapting to continuous process improvement, without compromising on quality. <input checked="" type="checkbox"/> To provide continuous support to our customers and go beyond their expectations in terms of delivery and after sale services. 	<ul style="list-style-type: none"> <input checked="" type="checkbox"/> In house R&D, manufacturing and testing facility is all located in a single premise at Rajkot Gujarat India. <input checked="" type="checkbox"/> Authorized channel partners in 20 different states in India. <input checked="" type="checkbox"/> Sales office in the UAE, Germany, Chile, Australia (Expanding).

We started building our products for a specific market segment and over the period of time we progressed to built it for various sectors that includes:

- | | | | | | |
|---|---|--|---|--|--|
| <input checked="" type="checkbox"/> Textile | <input checked="" type="checkbox"/> Water Treatment | <input checked="" type="checkbox"/> Energy & Power | <input checked="" type="checkbox"/> Packaging | <input checked="" type="checkbox"/> Pharmaceutical | <input checked="" type="checkbox"/> Oil & Gas |
| <input checked="" type="checkbox"/> Nuclear | <input checked="" type="checkbox"/> Marine | <input checked="" type="checkbox"/> Chemical | <input checked="" type="checkbox"/> Food and Beverage | <input checked="" type="checkbox"/> Steel & Cement | <input checked="" type="checkbox"/> Automotive |

We stand amongst the pioneers of the industry because of our following competitive advantages:

- Total quality management allow us to maintain the quality of our products,
- We follow genuine customer relationship policy and that help us to build trusted relationships.
- We believe in timely delivery and consistent quality standard, and this is possible due to the state of the art testing facility, that ensures our customers don't have any complains.
- Innovative products range with sophisticated and latest technology.
- Qualified customer service team, facilitate with the customers to resolve their respective query. Also feel free to ask for our customer references and product samples.

Uflow's Quality control is based on the platform of stringent process control by elimination of production variances; by a computerized integrated system we are able to guarantee the quality of products, and by recording each production step to ensure effective data analysis as well as a complete and efficient traceability of both components and finished products. This practice helps us in maintaining standards of high competitiveness in the marketplace.

Note: *For Any Other Information Contact Uflow.
* All Information may change without prior notice.



ANGLE SEAT VALVE
SERIES



Angle seat valves are 2/2 way pneumatically actuated piston valves. The piston actuator provides a linear motion to lift the seal off its seat. Because the seat is positioned under an angle, the flow is minimally impeded in the open position, resulting in an excellent flow rate and a low pressure loss. They are used to regulate the flow of liquids, gases, steam, vacuum and even aggressive fluids. They can also operate with high temperatures and high viscosity media, even under zero differential pressures. The robust design makes UFLOW angle seat valves a popular choice for harsh applications and they have very high life cycle. Therefore they are an excellent alternative to Ball valves with actuator combo. These valves are also suitable alternatives for solenoid valves, especially with contaminated, viscous media where typical solenoid valves would fail. They may be operated using a single acting or double acting configuration, which has an influence on its pressure rating.

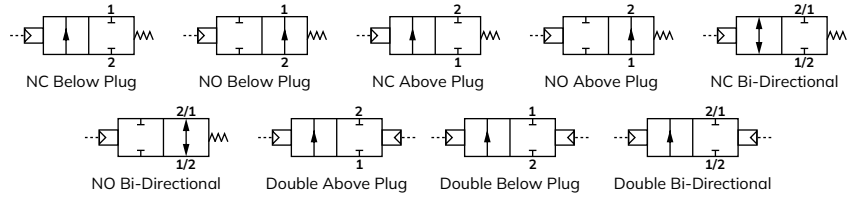

Specifications

Port :	Refer below technical data sheet (Available BSP / NPT)
End Connection :	Screwed / Flange / Tri-Clamp
Body & Sleeve Material :	SS ASTM A351 Grade CF8 / CF8M / CF3M
Seal :	TEFLON / PEEK / VITON
Shaft :	SS304 / SS316
Circumstance Temp :	-10°C to 70°C
Media Temp :	-10°C to 180°C

Features

- Convertible from single Acting to Double Acting.
- Multiple Function with the same operator - NC / NO / Bi-Directional.
- Rotatable Actuator- 360°.
- Transparent dome for visual confirmation of the valve's position/state
- Lubricated air not essential.
- Flow direction below or above the seat.
- Media: Steam, Air, Water, Chemical, Gases, Oil, Diesel, Hot Water.
- Application: Steam, Autoclave and Sterilizer, Ink and Paint dispensing, Industrial compressor bottling and dispensing equipment, textile dying and drying and pharmaceutical.

Section View



Actuator Type

Cover :	Nylon Glass-Filled (Corrosion resistive) with SS Liner
Seal :	NBR / VITON
Working Pressure :	Refer Below Pressure Chart Table
Life :	Three Million Cycle Tested
Other Technical Data :	Available on Request

Dimension With Screwed End (All dimensions in mm)

All Dimensions are approx.

Model No.	Actuator	Port Size	Diagram No.	A	B	C	D	E	F	G	H	I
ACP2054BNV0	40	½"	28.1	65	144	131	154	65	24	G¾"	32	M5
ACP2055BNV0	50	½"	28.1	65	153	141	163	70	24	G¾"	32	M5
ACP2056BNV0	63	½"	28.1	65	171	158	181	85	24	G¾"	32	M5
ACP3054BNV0	40	¾"	28.1	77	150	134	161	65	24	G¾"	32	M5
ACP3055BNV0	50	¾"	28.1	77	160	144	171	70	24	G¾"	32	M5
ACP3056BNV0	63	¾"	28.1	77	177	161	187	85	24	G¾"	32	M5
ACP4055BNV0	50	1"	28.1	89	177	157	185	70	24	G¾"	32	M5
ACP4056BNV0	63	1"	28.1	89	194	174	202	85	24	G¾"	32	M5
ACP4059BNV0	90	1"	28.1	89	221	201	229	126	24	G¾"	32	M5
ACP5056BNV0	63	1¼"	28.1	110	199	175	209	85	24	G¾"	32	M5
ACP5059BNV0	90	1¼"	28.1	110	233	209	244	126	24	G¾"	32	M5
ACP6056BNV0	63	1½"	28.1	124	212	184	220	85	24	G¾"	32	M5
ACP6059BNV0	90	1½"	28.1	124	239	212	247	126	24	G¾"	32	M5
ACP8059BNV0	90	2"	28.1	150	260	227	269	126	24	G¾"	32	M5
ACP9039BNV0	90	2½"	28.1	168	281	239	262	126	24	G¾"	32	M5

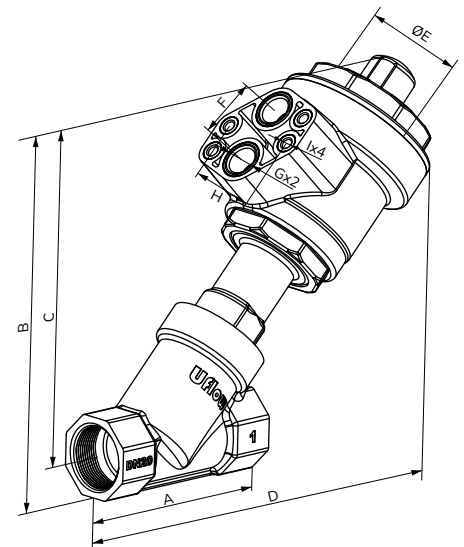

Diagram No. 28.1

Dimension With Flange (ASME 16.5 #150) (All dimensions in mm)

All Dimensions are approx.

Model No.	Actuator	Port Size	Diagram No.	A	B	C	D	E	F	G	H	I	J	K	L	M	NXO
ACP2054FNVO	40	½"	28.2	163	176	131	165	65	24	G¼"	32	M5	8	90	38	60	16X4
ACP2055FNVO	50	½"	28.2	163	186	141	175	70	24	G¼"	32	M5	8	90	38	60	16X4
ACP2056FNVO	63	½"	28.2	163	203	158	192	85	24	G¼"	32	M5	8	90	38	60	16X4
ACP3054FNVO	40	¾"	28.2	172	184	134	171	65	24	G¼"	32	M5	9	100	46	70	16X4
ACP3055FNVO	50	¾"	28.2	172	194	144	181	70	24	G¼"	32	M5	9	100	46	70	16X4
ACP3056FNVO	63	¾"	28.2	172	211	161	198	85	24	G¼"	32	M5	9	100	46	70	16X4
ACP4055FNVO	50	1"	28.2	181	212	157	196	70	24	G¼"	32	M5	10	110	54	79	16X4
ACP4056FNVO	63	1"	28.2	181	229	174	208	85	24	G¼"	32	M5	10	110	54	79	16X4
ACP4059FNVO	90	1"	28.2	181	256	201	240	126	24	G¼"	32	M5	10	110	54	79	16X4
ACP5056FNVO	63	1¼"	28.2	182	239	182	234	85	24	G¼"	32	M5	13	115	64	M5	M5
ACP5059FNVO	90	1¼"	28.2	182	267	209	262	126	24	G¼"	32	M5	13	115	64	M5	M5
ACP6056FNVO	63	1½"	28.2	212	247	184	242	85	24	G¼"	32	M5	13	125	76	98	16X4
ACP6059FNVO	90	1½"	28.2	212	274	212	269	126	24	G¼"	32	M5	13	125	76	98	16X4
ACP8059FNVO	90	2"	28.2	208	302	226	275	126	24	G¼"	32	M5	14	150	94	121	16X4
ACP9039FNVO	90	2½"	28.2	231	329	239	294	126	24	G¼"	32	M5	13	180	106	140	16X4

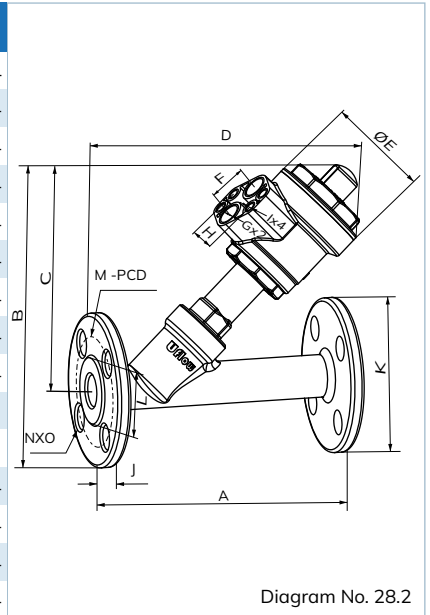

Diagram No. 28.2

Dimension With Tri-Clamp (All dimensions in mm)

All Dimensions are approx.

Model No.	Actuator	Port Size	Diagram No.	A	B	C	D	E	F	G	H	I
ACP2054TNVO	40	½"	28.3	163	176	131	165	65	24	G¼"	32	M5
ACP2055TNVO	50	½"	28.3	163	186	141	175	70	24	G¼"	32	M5
ACP2056TNVO	63	½"	28.3	163	203	158	192	85	24	G¼"	32	M5
ACP3054TNVO	40	¾"	28.3	172	184	134	171	65	24	G¼"	32	M5
ACP3055TNVO	50	¾"	28.3	172	194	144	181	70	24	G¼"	32	M5
ACP3056TNVO	63	¾"	28.3	172	211	161	198	85	24	G¼"	32	M5
ACP4055TNVO	50	1"	28.3	181	212	157	196	70	24	G¼"	32	M5
ACP4056TNVO	63	1"	28.3	181	229	174	208	85	24	G¼"	32	M5
ACP4059TNVO	90	1"	28.3	181	256	201	240	126	24	G¼"	32	M5
ACP5056TNVO	63	1¼"	28.3	182	239	182	234	85	24	G¼"	32	M5
ACP5059TNVO	90	1¼"	28.3	182	267	209	262	126	24	G¼"	32	M5
ACP6056TNVO	63	1½"	28.3	212	247	184	242	85	24	G¼"	32	M5
ACP6059TNVO	90	1½"	28.3	212	274	212	269	126	24	G¼"	32	M5
ACP8059TNVO	90	2"	28.3	208	302	226	275	126	24	G¼"	32	M5
ACP9039TNVO	90	2½"	28.3	231	329	239	294	126	24	G¼"	32	M5

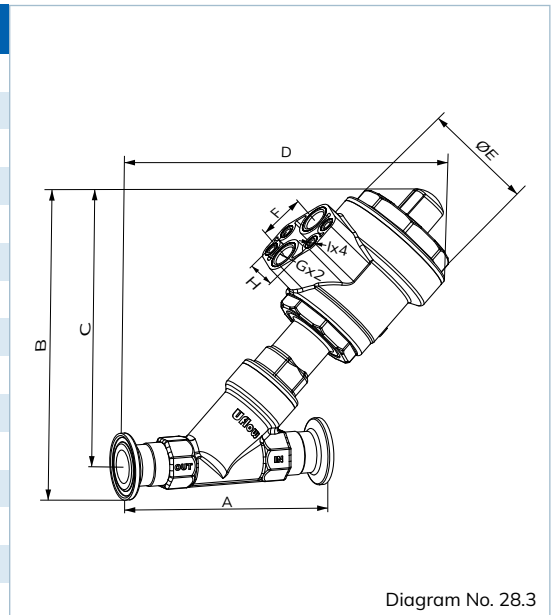

Diagram No. 28.3

Technical Data

Pipe (Inch)	Body Material	Orifice (mm)	Seal & 'O' Ring Material	Flow Factor Kv m³ / hr
½"	CF8 / CF8M	15	PTFE / PEEK / VITON	6
¾"	CF8 / CF8M	20	PTFE / PEEK / VITON	10.9
1"	CF8 / CF8M	25	PTFE / PEEK / VITON	21
1¼"	CF8 / CF8M	32	PTFE / PEEK / VITON	35
1½"	CF8 / CF8M	40	PTFE / PEEK / VITON	49
2"	CF8 / CF8M	50	PTFE / PEEK / VITON	68
2½"	CF8 / CF8M	65	PTFE / PEEK / VITON	120

Pressure Chart

Pipe (Inch)	Actuator	NC				NO				Double Acting			
		Above Plug		Below Plug		Above Plug		Below Plug		Above Plug		Below Plug	
		Pilot Pressure	Line Pressure	Pilot Pressure	Line Pressure	Pilot Pressure	Line Pressure	Pilot Pressure	Line Pressure	Pilot Pressure	Line Pressure	Pilot Pressure	Line Pressure
½"	40	4	16	-	-	6	16	-	-	4.5	20	4	16
		4.5	20	-	-	6	18	-	-	3	16	4.5	20
¾"	40	5.2	16	-	-	-	-	-	-	3.8	16	4.5	16
		6.2	19	-	-	-	-	-	-	5	20	5	20
		-	-	-	-	-	-	-	-	-	-	-	-
¾"	50	4.5	16	-	-	4	13	6.5	12	3.5	16	5	16
		5.5	20	-	-	-	-	-	-	4.5	20	5.5	20
		-	-	-	-	-	-	-	-	-	-	-	-
1"	63	5	16	-	-	4.5	15	7	8	3.5	16	4.5	16
		5.8	20	-	-	-	-	-	-	4.5	20	5	20
		-	-	-	-	-	-	-	-	-	-	-	-
1¼"	63	6	16	-	-	4.5	13	-	-	5	16	6	16
		6.5	20	-	-	-	-	-	-	6	20	6.5	20
		7	12	-	-	-	-	7	9	5	10	-	-
1½"	63	-	-	-	-	4.5	8	-	-	7	16	-	-
		-	-	-	-	-	-	-	-	-	-	-	-
		4.5	16	-	-	4.5	10	7	9	4.5	16	4	16
1½"	90	5	20	-	-	-	-	-	-	5	20	5	20
		-	-	-	-	-	-	-	-	-	-	-	-
		6.5	16	-	-	6	16	7	10	5	16	7	18
2"	90	7	19	-	-	-	-	-	-	6.2	20	-	-
		-	-	-	-	-	-	-	-	-	-	-	-
		7	10.5	-	-	-	-	-	-	-	-	-	-
2½"	90	5	7	-	-	-	-	-	-	-	-	-	-

Pressure Above Plug

Pressure Below Plug

	A	B
Normally Open	Pilot Inlet	Exhaust
Normally Close	Exhaust	Pilot Inlet

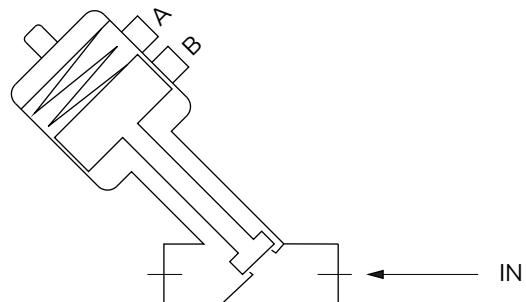
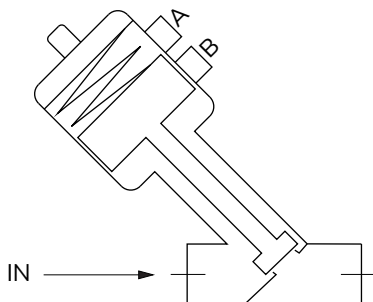

ANGLE SEAT VALVE WITH PLASTIC ACTUATOR OPERATED MODEL IDENTIFICATION CHART

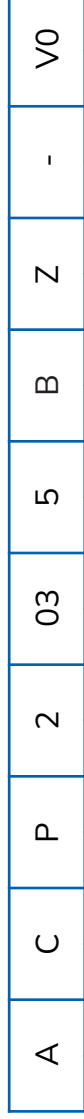

PRODUCT TYPE	SEAL MATERIAL	PORT SIZE	PRESSURE RANGE	ACTUATOR SIZE	PORT CONNECTION	VALVE POSITION	CONFIGURATION	VERSION
A	P	2	02	4	B	N	BLANK	V0
	K	3	14	5	N	Z	C1	V1
		4	03	6	F	D	C2	V2
		5	05	9	T	C	C3	V3
		6	11	1	P	O	:	:
		8	04			B	C9	V9
		9				R	CA	VA
						L	CB	VB
						I		

BODY MATERIAL	
C	CF8
M	CF8M
3	CF3M

ACP2035BZV0
1/2" ANGLE SEAT VALVE CF8-PTFE-0 TO 7 Bar-50 NAMUR-BSP-NO ABOVE

Our Clients



Global Presence...



Made In India



CONTACT US:

✉ sales@uflowvalve.com ☎ +91 89059 07070 📞 +91-2827-254343 🌐 www.uflowvalve.com

📍 Uflow Automation, Ankur Industrial Complex, Sur vey No: 275/276, Plot No: 31, Nr. Intol Cast Pvt. Ltd. Shapar(Veraval) Dist.: Gujarat (India) - 360 024.