

**ONE TOUCH FITTINGS
DIFFERENT DIA. STRAIGHT UNION**

Automation
Simplified...



- Solenoid Valve
- Angle Seat Valve
- Rotary Coupling
- Pneumatic Directional Control Valve
- Actuator
- Cylinder
- One Tuch Fitting
- Ball Valve
- Butterfly Valve

Country of Origin - INDIA



Specifications

Fluid :	Air																														
Max. operating pressure :	10 Bar																														
Ambient temperature :	-10°C to +60°C																														
Threaded connection :	Male : R - Taper thread, Female : G - Parallel thread																														
Media temperature :	+5°C to 50°C																														
Applicable tube material :	Nylon, Polyurethane																														
Applicable tube size (OD) :	Ø4, Ø6, Ø8, Ø10, Ø12, Ø14, Ø16																														
Recommended tolerance for tube OD :	±0.1 mm																														
Recommended minimum wall thickness of tubes :	<table border="1"> <thead> <tr> <th colspan="2">Nylon</th> <th colspan="2">PU</th> </tr> <tr> <th>Tube OD (mm)</th> <th>Thickness (mm)</th> <th>Tube OD (mm)</th> <th>Thickness (mm)</th> </tr> </thead> <tbody> <tr> <td>Ø4</td> <td rowspan="7">1</td> <td>Ø4</td> <td>1</td> </tr> <tr> <td>Ø6</td> <td>Ø6</td> <td>1</td> </tr> <tr> <td>Ø8</td> <td>Ø8</td> <td>1.5</td> </tr> <tr> <td>Ø10</td> <td>Ø10</td> <td>1.5</td> </tr> <tr> <td>Ø12</td> <td>Ø12</td> <td>2</td> </tr> <tr> <td>Ø14</td> <td>Ø14</td> <td>2</td> </tr> <tr> <td>Ø16</td> <td>Ø16</td> <td>2.5</td> </tr> </tbody> </table>	Nylon		PU		Tube OD (mm)	Thickness (mm)	Tube OD (mm)	Thickness (mm)	Ø4	1	Ø4	1	Ø6	Ø6	1	Ø8	Ø8	1.5	Ø10	Ø10	1.5	Ø12	Ø12	2	Ø14	Ø14	2	Ø16	Ø16	2.5
Nylon		PU																													
Tube OD (mm)	Thickness (mm)	Tube OD (mm)	Thickness (mm)																												
Ø4	1	Ø4	1																												
Ø6		Ø6	1																												
Ø8		Ø8	1.5																												
Ø10		Ø10	1.5																												
Ø12		Ø12	2																												
Ø14		Ø14	2																												
Ø16		Ø16	2.5																												

Features

- ☑ Compact & Captivating Design
- ☑ All Threaded nipples has plastic portion that is capable of rotating 360°
- ☑ Full bore piping enables smooth flow of fluids.
- ☑ New Design SS collet
- ☑ Air tight sealing of tubes
- ☑ Compatible with both Nylon & PU pipes
- ☑ Male Taper threads with PTFE coating
- ☑ Durable & Maintenance free
- ☑ Robust collet design lets the fitment & function remains unaffected even due to vibration.
- ☑ Simple & fast connection of tube just by plugging-in manually and similarly smooth way of pulling-out just by the press of plastic collet cap.

Features

One-touch fitting can be effectively used in all compressed air applications
Some of the pneumatic application include

- ☑ Pneumatic cylinders (all types)
- ☑ All compressed air lines, machinery of all kinds wherever pneumatic systems are used
- ☑ Directional control valves(DCV), solenoid valves(SOV) and other valves
- ☑ Pneumatic control & circuit panels
- ☑ Air preparation units like filter, regulator and lubricators(FRL)

Different Dia. Straight Union



Dimension Drawing (All dimensions in mm)

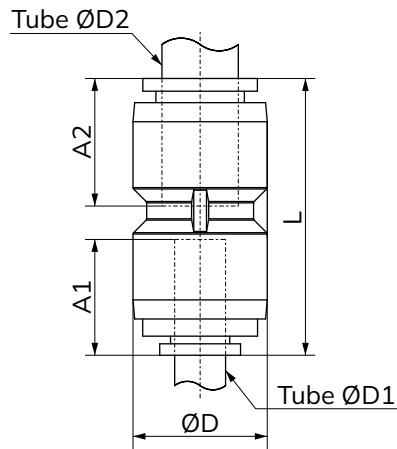

Technical Data

Model No.	Tube OD		ØD	L	A1	A2
	ØD1	ØD2				
VO220406	4	6	12.6	35.3	15.9	15
VO220608	6	8	15	36.6	16.3	16
VO220610	6	10	18.5	40.6	17.2	18.4
VO220810	8	10	18.5	41.1	17.7	18.4
VO220812	8	12	21	43.5	18.2	20
VO221012	10	12	31.1	44	20.2	20
VO221216	12	16	25.6	48.3	21.8	22

ONE TOUCH FITTINGS IDENTIFICATION CHART

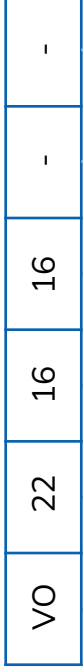

PRODUCT TYPE	PRODUCT SUB TYPE	PRODUCT SUB TYPE	APPLICABLE TUBING OD	APPLICABLE TUBING OD	APPLICABLE TUBING OD	APPLICABLE TUBING OD	APPLICABLE TUBING OD
VO	One Touch Fitting	21 Straight Union	41 Male Connector (Internal Hexagon Socket)	16 With Applicable Tubing OD Ø16MM	Blank	Blank	Blank
VS	Self Sealing Fitting	22 Different Dia. Straight Union	42 Single Swivel (Internal Hexagon Socket)	14 With Applicable Tubing OD Ø14MM	16 TO Ø16MM	16 TO Ø16MM	A M5X0.8
VF	Flow Control	23 Union Elbow	43 Single Swivel (Slotted Head)	12 With Applicable Tubing OD Ø12MM	14 TO Ø14MM	14 TO Ø14MM	B R 1/8
		24 Union Elbow Reducer	44 Single Swivel (Hexagon Head)	10 With Applicable Tubing OD Ø10MM	12 TO Ø12MM	12 TO Ø12MM	C R 1/4
		25 Union Tee	45 Double Swivel	08 With Applicable Tubing OD Ø08MM	10 TO Ø10MM	10 TO Ø10MM	D R 3/8
		26 Union Tee Reducer	46 Triple Swivel	06 With Applicable Tubing OD Ø06MM	08 TO Ø08MM	08 TO Ø08MM	E R 1/2
		27 Union 'Y'	47 Multi Distributor Union	04 With Applicable Tubing OD Ø04MM	06 TO Ø06MM	06 TO Ø06MM	F 1/8
		28 Union 'Y' Reducer	48 Multi Distributor Male		04 TO Ø04MM	04 TO Ø04MM	G 1/4
		29 Bulk Head Union	49 Cross Union				H 3/4
		30 Male Connector	50 Plug				I 3/8
		31 Bulk Head Female Connector	51 Flow Control Inline Type				J 1/2
		32 Female Connector	52 Flow Control Regular				K 1
		33 Male Elbow					
		34 Extended Male Elbow					
		35 Female Elbow					
		36 Male Branch Tee					
		37 Female Branch Tee					
		38 Male Run Tee					
		39 Female Run Tee					
		40 Male Branch 'y'					

VO221616

DIFFERENT DIA. STRAIGHT UNIONTYPE CONNECTOR WITH APPLICABLE TUBING OD Ø16MM TO Ø16MM

Global Presence...



Made In India



CONTACT US:

✉ sales@uflowvalve.com ☎ +91 89059 07070 📞 +91-2827-254343 🌐 www.uflowvalve.com

📍 Uflow Automation, Ankur Industrial Complex, Sur vey No: 275/276, Plot No: 31, Nr. Intol Cast Pvt. Ltd. Shapar(Veraval) Dist.: Gujarat (India) - 360 024.