

Automation
 Simplified...



- Solenoid Valve
- Angle Seat Valve
- Rotary Coupling
- Pneumatic Directional Control Valve
- Actuator
- Cylinder
- One Tuch Fitting
- Ball Valve
- Butterfly Valve

Country of Origin - INDIA



Specifications

Fluid :	Air																													
Max. operating pressure :	10 Bar																													
Ambient temperature :	-10°C to +60°C																													
Threaded connection :	Male : R - Taper thread, Female : G - Parallel thread																													
Media temperature :	+5°C to 50°C																													
Applicable tube material :	Nylon, Polyurethane																													
Applicable tube size (OD) :	Ø4, Ø6, Ø8, Ø10, Ø12, Ø14, Ø16																													
Recommended tolerance for tube OD :	±0.1 mm																													
Recommended minimum wall thickness of tubes :	<table border="1"> <thead> <tr> <th colspan="2">Nylon</th> <th colspan="2">PU</th> </tr> <tr> <th>Tube OD (mm)</th> <th>Thickness (mm)</th> <th>Tube OD (mm)</th> <th>Thickness (mm)</th> </tr> </thead> <tbody> <tr> <td>Ø4</td> <td rowspan="7">1</td> <td>Ø4</td> <td>1</td> </tr> <tr> <td>Ø6</td> <td>Ø6</td> <td>1</td> </tr> <tr> <td>Ø8</td> <td>Ø8</td> <td>1.5</td> </tr> <tr> <td>Ø10</td> <td>Ø10</td> <td>1.5</td> </tr> <tr> <td>Ø12</td> <td>Ø12</td> <td>2</td> </tr> <tr> <td rowspan="2">Ø14</td> <td>Ø14</td> <td>2</td> </tr> <tr> <td>Ø16</td> <td>2.5</td> </tr> </tbody> </table>	Nylon		PU		Tube OD (mm)	Thickness (mm)	Tube OD (mm)	Thickness (mm)	Ø4	1	Ø4	1	Ø6	Ø6	1	Ø8	Ø8	1.5	Ø10	Ø10	1.5	Ø12	Ø12	2	Ø14	Ø14	2	Ø16	2.5
Nylon		PU																												
Tube OD (mm)	Thickness (mm)	Tube OD (mm)	Thickness (mm)																											
Ø4	1	Ø4	1																											
Ø6		Ø6	1																											
Ø8		Ø8	1.5																											
Ø10		Ø10	1.5																											
Ø12		Ø12	2																											
Ø14		Ø14	2																											
		Ø16	2.5																											

Features

- ☑ Compact & Captivating Design
- ☑ All Threaded nipples has plastic portion that is capable of rotating 360°
- ☑ Full bore piping enables smooth flow of fluids.
- ☑ New Design SS collet
- ☑ Air tight sealing of tubes
- ☑ Compatible with both Nylon & PU pipes
- ☑ Male Taper threads with PTFE coating
- ☑ Durable & Maintenance free
- ☑ Robust collet design lets the fitment & function remains unaffected even due to vibration.
- ☑ Simple & fast connection of tube just by plugging-in manually and similarly smooth way of pulling-out just by the press of plastic collet cap.

Features

One-touch fitting can be effectively used in all compressed air applications
Some of the pneumatic application include

- ☑ Pneumatic cylinders (all types)
- ☑ All compressed air lines, machinery of all kinds wherever pneumatic systems are used
- ☑ Directional control valves(DCV), solenoid valves(SOV) and other valves
- ☑ Pneumatic control & circuit panels
- ☑ Air preparation units like filter, regulator and lubricators(FRL)

Union Elbow



Dimension Drawing (All dimensions in mm)

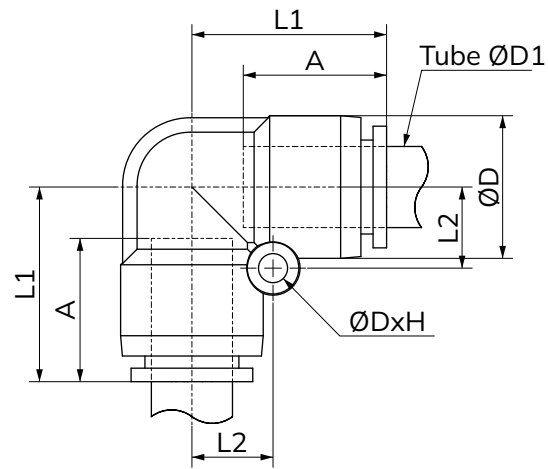

Technical Data

Model No.	Tube OD ØD1	ØD	L1	L2	A	ØDXH
VO230404	4	10.6	17.7	6.5	14.9	Ø3.3X11
VO230606	6	12.8	20	7.5	15	Ø3.3X13
VO230808	8	15	25	9	17.2	Ø3.3X15.5
VO231010	10	18.5	26.4	11	19.2	Ø4.3X19
VO231212	12	21.1	28.8	12	21.2	Ø4.3X21.5
VO231414	14	23.1	29.8	13	20.7	Ø4.3X23.5
VO231616	16	25.6	31.3	14.5	22.2	Ø4.3X26

Global Presence...



Made In India



CONTACT US:

✉ sales@uflowvalve.com ☎ +91 89059 07070 📞 +91-2827-254343 🌐 www.uflowvalve.com

📍 Uflow Automation, Ankur Industrial Complex, Sur vey No: 275/276, Plot No: 31, Nr. Intol Cast Pvt. Ltd. Shapar(Veraval) Dist.: Gujarat (India) - 360 024.