

Automation
Simplified...



Solenoid Valve

Angle Seat Valve

Rotary Coupling

Pneumatic Directional Control Valve

Actuator

Cylinder

One Tuch Fitting

Ball Valve

Butterfly Valve

Specifications

| Fluid : | Air | | | | | | | | | | | | | | | | | | | | | | | | | | | | | | |
|--|---|--------------|----------------|----|--|--------------|----------------|--------------|----------------|----|---|----|---|----|----|---|----|----|-----|-----|-----|-----|-----|-----|---|-----|-----|---|-----|-----|-----|
| Max. operating pressure : | 10 Bar | | | | | | | | | | | | | | | | | | | | | | | | | | | | | | |
| Ambient temperature : | -10°C to +60°C | | | | | | | | | | | | | | | | | | | | | | | | | | | | | | |
| Threaded connection : | Male : R - Taper thread, Female : G - Parallel thread | | | | | | | | | | | | | | | | | | | | | | | | | | | | | | |
| Media temperature : | +5°C to 50°C | | | | | | | | | | | | | | | | | | | | | | | | | | | | | | |
| Applicable tube material : | Nylon, Polyurethane | | | | | | | | | | | | | | | | | | | | | | | | | | | | | | |
| Applicable tube size (OD) : | Ø4, Ø6, Ø8, Ø10, Ø12, Ø14, Ø16 | | | | | | | | | | | | | | | | | | | | | | | | | | | | | | |
| Recommended tolerance for tube OD : | ±0.1 mm | | | | | | | | | | | | | | | | | | | | | | | | | | | | | | |
| Recommended minimum wall thickness of tubes : | <table border="1"> <thead> <tr> <th colspan="2">Nylon</th> <th colspan="2">PU</th> </tr> <tr> <th>Tube OD (mm)</th> <th>Thickness (mm)</th> <th>Tube OD (mm)</th> <th>Thickness (mm)</th> </tr> </thead> <tbody> <tr> <td>Ø4</td> <td rowspan="7">1</td> <td>Ø4</td> <td>1</td> </tr> <tr> <td>Ø6</td> <td>Ø6</td> <td>1</td> </tr> <tr> <td>Ø8</td> <td>Ø8</td> <td>1.5</td> </tr> <tr> <td>Ø10</td> <td>Ø10</td> <td>1.5</td> </tr> <tr> <td>Ø12</td> <td>Ø12</td> <td>2</td> </tr> <tr> <td>Ø14</td> <td>Ø14</td> <td>2</td> </tr> <tr> <td>Ø16</td> <td>Ø16</td> <td>2.5</td> </tr> </tbody> </table> | Nylon | | PU | | Tube OD (mm) | Thickness (mm) | Tube OD (mm) | Thickness (mm) | Ø4 | 1 | Ø4 | 1 | Ø6 | Ø6 | 1 | Ø8 | Ø8 | 1.5 | Ø10 | Ø10 | 1.5 | Ø12 | Ø12 | 2 | Ø14 | Ø14 | 2 | Ø16 | Ø16 | 2.5 |
| Nylon | | PU | | | | | | | | | | | | | | | | | | | | | | | | | | | | | |
| Tube OD (mm) | Thickness (mm) | Tube OD (mm) | Thickness (mm) | | | | | | | | | | | | | | | | | | | | | | | | | | | | |
| Ø4 | 1 | Ø4 | 1 | | | | | | | | | | | | | | | | | | | | | | | | | | | | |
| Ø6 | | Ø6 | 1 | | | | | | | | | | | | | | | | | | | | | | | | | | | | |
| Ø8 | | Ø8 | 1.5 | | | | | | | | | | | | | | | | | | | | | | | | | | | | |
| Ø10 | | Ø10 | 1.5 | | | | | | | | | | | | | | | | | | | | | | | | | | | | |
| Ø12 | | Ø12 | 2 | | | | | | | | | | | | | | | | | | | | | | | | | | | | |
| Ø14 | | Ø14 | 2 | | | | | | | | | | | | | | | | | | | | | | | | | | | | |
| Ø16 | | Ø16 | 2.5 | | | | | | | | | | | | | | | | | | | | | | | | | | | | |

Features

- ☑ Compact & Captivating Design
- ☑ All Threaded nipples has plastic portion that is capable of rotating 360°
- ☑ Full bore piping enables smooth flow of fluids.
- ☑ New Design SS collet
- ☑ Air tight sealing of tubes
- ☑ Compatible with both Nylon & PU pipes
- ☑ Male Taper threads with PTFE coating
- ☑ Durable & Maintenance free
- ☑ Robust collet design lets the fitment & function remains unaffected even due to vibration.
- ☑ Simple & fast connection of tube just by plugging-in manually and similarly smooth way of pulling-out just by the press of plastic collet cap.

Features

One-touch fitting can be effectively used in all compressed air applications
Some of the pneumatic application include

- ☑ Pneumatic cylinders (all types)
- ☑ All compressed air lines, machinery of all kinds wherever pneumatic systems are used
- ☑ Directional control valves(DCV), solenoid valves(SOV) and other valves
- ☑ Pneumatic control & circuit panels
- ☑ Air preparation units like filter, regulator and lubricators(FRL)

Union Tee



Dimension Drawing (All dimensions in mm)

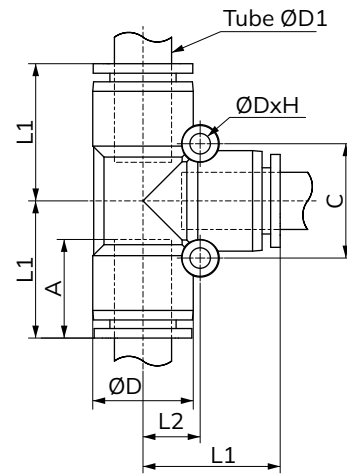

Technical Data

| Model No. | Tube OD ØD1 | ØD | L1 | L2 | C | A | ØDXH |
|-----------|-------------|------|------|------|----|------|-----------|
| VO250404 | 4 | 10.6 | 17.7 | 6.5 | 13 | 14.9 | Ø3.3X11 |
| VO250606 | 6 | 12.8 | 20 | 7.5 | 15 | 16 | Ø3.3X13 |
| VO250808 | 8 | 15 | 24 | 9 | 18 | 17.2 | Ø3.3X15.5 |
| VO251010 | 10 | 18.5 | 26.4 | 11 | 22 | 19.2 | Ø4.3X19 |
| VO251212 | 12 | 21.1 | 28.8 | 12 | 24 | 20.7 | Ø4.3X20.5 |
| VO251414 | 14 | 23.1 | 29.8 | 13 | 26 | 20.7 | Ø4.3X23.5 |
| VO251616 | 16 | 25.6 | 31.3 | 14.5 | 29 | 22.2 | Ø4.3X26 |

ONE TOUCH FITTINGS IDENTIFICATION CHART

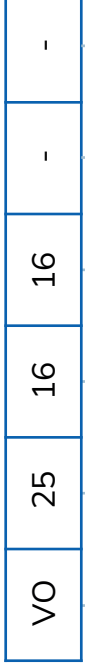

| PRODUCT TYPE | PRODUCT SUB TYPE | PRODUCT SUB TYPE | APPLICABLE TUBING OD | APPLICABLE TUBING OD | APPLICABLE TUBING OD | APPLICABLE TUBING OD | APPLICABLE TUBING OD |
|--------------|----------------------|----------------------------------|---|----------------------|---------------------------------|----------------------|----------------------|
| VO | One Touch Fitting | 21 Straight Union | 41 Male Connector (Internal Hexagon Socket) | 16 | With Applicable Tubing OD Ø16MM | Blank | Blank |
| VS | Self Sealing Fitting | 22 Different Dia. Straight Union | 42 Single Swivel (Internal Hexagon Socket) | 14 | With Applicable Tubing OD Ø14MM | 16 | TO Ø16MM |
| VF | Flow Control | 23 Union Elbow | 43 Single Swivel (Slotted Head) | 12 | With Applicable Tubing OD Ø12MM | 14 | TO Ø14MM |
| | | 24 Union Elbow Reducer | 44 Single Swivel (Hexagon Head) | 10 | With Applicable Tubing OD Ø10MM | 12 | TO Ø12MM |
| | | 25 Union Tee | 45 Double Swivel | 08 | With Applicable Tubing OD Ø08MM | 10 | TO Ø10MM |
| | | 26 Union Tee Reducer | 46 Triple Swivel | 06 | With Applicable Tubing OD Ø06MM | 08 | TO Ø08MM |
| | | 27 Union 'Y' | 47 Multi Distributor Union | 04 | With Applicable Tubing OD Ø04MM | 06 | TO Ø06MM |
| | | 28 Union 'Y' Reducer | 48 Multi Distributor Male | | | 04 | TO Ø04MM |
| | | 29 Bulk Head Union | 49 Cross Union | | | | |
| | | 30 Male Connector | 50 Plug | | | | |
| | | 31 Bulk Head Female Connector | 51 Flow Control Inline Type | | | | |
| | | 32 Female Connector | 52 Flow Control Regular | | | | |
| | | 33 Male Elbow | | | | | |
| | | 34 Extended Male Elbow | | | | | |
| | | 35 Female Elbow | | | | | |
| | | 36 Male Branch Tee | | | | | |
| | | 37 Female Branch Tee | | | | | |
| | | 38 Male Run Tee | | | | | |
| | | 39 Female Run Tee | | | | | |
| | | 40 Male Branch 'Y' | | | | | |
| | | | | | | | |
| | | | | | | | |
| | | | | | | | |
| | | | | | | | |
| | | | | | | | |
| | | | | | | | |
| | | | | | | | |
| | | | | | | | |
| | | | | | | | |
| | | | | | | | |
| | | | | | | | |
| | | | | | | | |
| | | | | | | | |
| | | | | | | | |
| | | | | | | | |

UNION TEE TYPE CONNECTOR WITH APPLICABLE TUBING OD Ø16MM TO Ø16MM

VO251616

Global Presence...



Made In India



CONTACT US:

✉ sales@uflowvalve.com ☎ +91 89059 07070 📞 +91-2827-254343 🌐 www.uflowvalve.com

📍 Uflow Automation, Ankur Industrial Complex, Sur vey No: 275/276, Plot No: 31, Nr. Intol Cast Pvt. Ltd. Shapar(Veraval) Dist.: Gujarat (India) - 360 024.